

# MAINTENANCE

GB

## EVERY 15,000 OPERATING HOURS

### MIN. PRESSURE valve (fig.13)

Open door (F) (see fig.7) and bleed all air off the tank through the cock (1).

Replace gaskets (2) and (3).

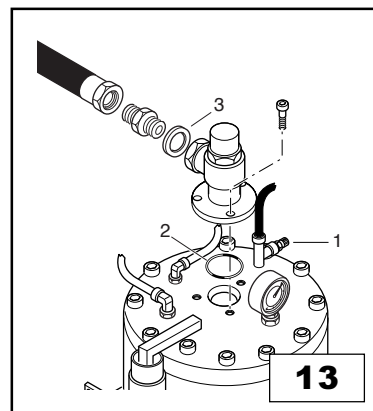

## EVERY 20,000 OPERATING HOURS

### Replace TRANSMISSION BELT (fig.12)

Proceed as follows:

- Open door (D) (see fig.7) and remove roller/belt protection panel.
- Loosen screws (1), (2) and (3) and turn nut (4) anti-clockwise until it stops.
- Remove the belt and replace with a new belt.
- Partially screw nut (4), move the tester close (see paragraph "check belt tension")

to "test" and read the value.

- Turn the nut (4) clockwise to increase belt tension or anti-clockwise to decrease belt tension.

• Tighten screws (1), (2) and (3) and check frequency value once again. Repeat the above steps until reaching optimal value, as indicated in the table (see page12).

- **Also replace**
- Compressor seal ring
- Tank safety valve

## MAINTENANCE SUMMARY TABLE

OSeating HRurs	ManIntenanFe
After first 100	Check: oil level, belt tensioning, proper screw tightening, fittings, room temperature Change oil filter
Every 300	Clean air filter and prefilter
Every 500	Check oil level
Every 2,000	Grease electric motor bearings
Every 3,000	Change the air filter element
After first 2,000 and then every 4,000	Change: oil, oil filter and oil separator filter
Every 10,000	Check belt tensioning
Every 15,000	Change MPV gaskets
Every 20,000	Change: transmission belt, compressor ring and tank safety valve

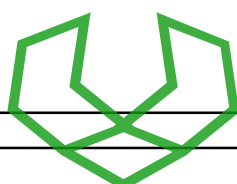

# БВА Сервис

Roter Giga - Cod.197796000 - ed.1 07/2001

## ОБСЛУЖИВАНИЕ КОМПРЕССОРОВ